

# Lord Nelson Victory Tug 37

1982-89

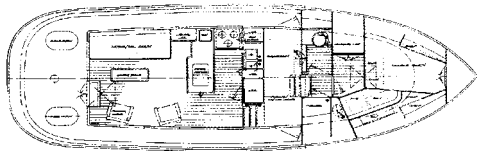
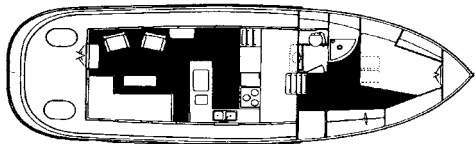

**B**ased on a traditional New England workboat hull, the Victory Tug 37 is a long-range cruiser with a yacht-like interior to go with her salty profile. This is a yacht that gets attention everywhere she goes. The Victory Tug was built in Taiwan on a solid fiberglass displacement hull with a plumb bow, full-length (ballasted) keel, and a rounded transom. Her teak batten interior, functional pilothouse, large galley, and wide walkaround decks with substantial bulwarks will appeal to the discerning yachtsman. The salon and galley are three steps down from the pilothouse. The U-shaped galley has a serving counter, and the convertible salon settee has storage space below. A pantry door in the galley opens to the engine room. The salon sole is teak and holly, and the overhead is tongue and groove teak. Forward of the pilothouse, the stateroom features a double berth and head with stall shower. The original teak decks were ultimately eliminated in favor of fiberglass, and the teak handrails were replaced with stainless steel late in her production run. A popular boat with 76 delivered, the Victory Tug 37 has a cruising range of 800-900 miles at 7 knots with a single 150hp Cummins diesel.

## Specifications

Length Overall.....	36'11"	Clearance .....	12'6"
Length WL .....	33'4"	Fuel .....	250 gals.
Beam.....	13'2"	Water .....	185 gals.
Draft.....	3'6"	Waste.....	40 gals.
Weight.....	20,500#	Hull Type.....	Displacement