

Present 42 Sundeck

1984-89

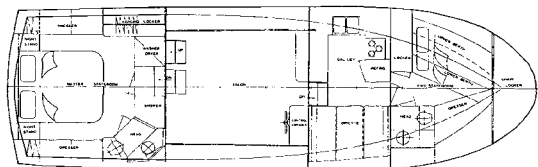

Built by CHB (Chung Hwa Boatworks) in Taiwan, the Present 42 was a popular Asian import during the 1980s thanks to an impressive mix of modern styling, traditional teak interior, and a very competitive price. Her sundeck design allows for maximum space below as well as on deck, and an efficient semi-displacement hull makes the Present 42 an economical boat to operate. Belowdecks, the two-stateroom interior features a roomy main salon with standard lower helm forward to starboard. A breakfast bar to port overlooks the galley, and a sliding door at the helm provides easy deck access. The parquet salon sole is an attractive feature, and large windows provide plenty of natural lighting and good helm visibility. Opposite the galley is a convertible booth dinette. Forward, the guest stateroom has over/under berths to port and private access to the forward head. Aft, the full-width master stateroom has a walkaround queen berth, private en-suite head with stall shower, and washer/dryer cabinet. The Present's covered aft deck is perfect for entertaining several friends. Twin 135hp or 225hp Lehman diesels—or twin 165hp or 225hp Perkins diesels—offer cruising speeds from 10 to 14 knots.



Specifications

Length Overall.....	41'10"	Clearance	16'4"
Length WL	38'0"	Fuel	600 gals.
Beam.....	13'8"	Water	200 gals.
Draft.....	3'6"	Waste.....	50 gals.
Weight.....	26,000#	Hull Type.....	Semi-Disp.